

D.C. geared motors

- Speed range : 1 to 400 rpm
80803 / 80804 : cyclic operation only
- Gearboxes with torque ratings from : 1.2 to 2 Nm, solid metal gears
1.2 Nm versions provide long life
- Motors : max. usable power 17 W

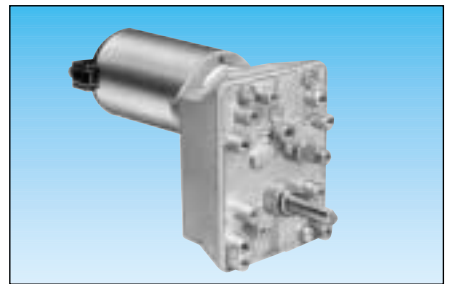

Applications

- Medical radiography
- Drink dispensers
- Fire shutters
- Moving advertising panels
- Adjusting mechanisms for woodworking machinery
- Amusements : pinball machines
- Livestock feeding systems
- Fitness equipment
- Etc.

Made to order products, available on request

Motors :

- specific interference suppression
- other supply voltages
- motors with 1 ball bearing
- shaft lengths at front and/or rear
- magnetic encoder 5 pulses per revolution
- other front fixing plates

Gearboxes :

- needle bearings for 81 032 1
- special cover for 81 032 1
- special lubrication
- special shaft
- other reduction ratios

Type

		82 802 0	82 802 0	82 802 0
Nominal voltage		12 V	24 V	48 V
Output speed (rpm)	Ratios (i)	Part numbers		
400	13/2	—	—	—
301	855/99	—	—	—
161	728/45	—	—	—
120	65/3	—	—	—
103	455/18	—	—	—
100	26	●	●	●
80	32.5	●	●	●
60	130/3	●	●	●
40	65	—	—	—
38	67.6	●	●	●
30	598/7	●	●	●
24	325/3	—	—	—
20	130	●	●	●
16	162.5	—	—	—
8	325	—	—	—
4	650	—	—	—
1	2600	—	—	—

Standard gearbox shaft : see dimensions

General characteristics

		82 800 0	82 800 0	82 800 0
Gearbox		81 032 1	81 032 1	81 032 1
Maximum permitted torque on gearbox for continuous rating	For 1 million revolutions For 10 million revolutions	Nm	—	—
Axial load (dynamic)		daN	3.5	3.5
Radial load (dynamic)		daN	5	5
Maximum usable power		W	16.3	17
Nominal usable power		W	15.7	15.6
Gearbox case temperature rise		°C	44	40
Weight		g	670	670

Standard gearbox shaft : see dimensions

	82 800 0	82 800 0	82 800 0
Gearbox shaft Ø 8 mm 79 261 300	—	—	—
Ø 8 mm with hole 79 261 309	—	—	—
Ø 8 mm flatted front and rear 79 261 314	—	—	—
Magnetic encoder 1 pulse per revolution to SP 1737.00	●	●	●

Nominal speed and torque curves

The shaded zone represents the operating range of the geared motor.

The horizontal line marks the maximum torque available in continuous duty cycle for a given life.

For higher torque ratings, service life will be reduced.

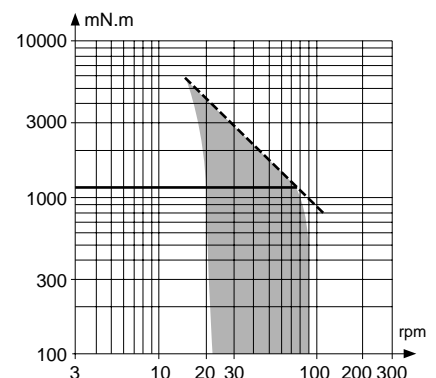

Other information

Basic principles : see page 1/7.
Motor 82 800 0 : see page 1/10.
82 800 0 version with encoder : see pages 1/10 - 1/43.

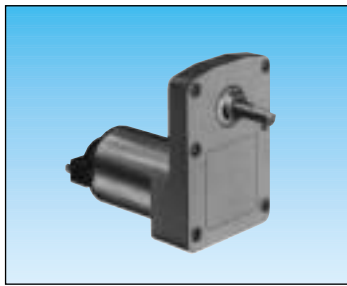
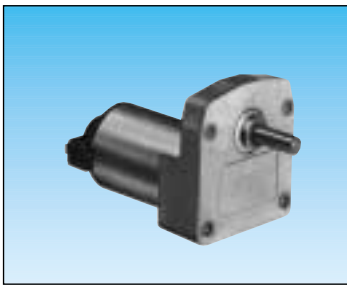

80 803 0		80 803 0		80 803 0		80 804 0		80 804 0		80 804 0	
12 V	24 V	48 V	12 V	24 V	48 V	12 V	24 V	48 V	12 V	24 V	48 V
•	•	•	—	—	—	—	—	—	—	—	—
80 803 005	80 803 008	•	—	—	—	—	—	—	—	—	—
•	•	•	—	—	—	—	—	—	—	—	—
—	—	—	—	—	—	—	—	—	—	—	—
80 803 006	80 803 009	•	—	—	—	—	—	—	—	—	—
80 803 007	80 803 010	•	—	—	—	—	—	—	—	—	—
—	—	—	—	—	—	—	—	—	—	—	—
—	—	—	—	—	—	80 804 006	80 804 009	•	—	—	—
—	—	—	—	—	—	—	—	—	—	—	—
—	—	—	—	—	—	80 804 007	80 804 010	•	—	—	—
—	—	—	—	—	—	80 804 008	80 804 011	•	—	—	—
—	—	—	—	—	—	•	•	•	—	—	—

82 800 0	82 800 0	82 800 0	82 800 0	82 800 0	82 800 0
81 043 0	81 043 0	81 043 0	81 044 0	81 044 0	81 044 0
2	2	2	2	2	2
—	—	—	—	—	—
2	2	2	2	2	2
2	2	2	2	2	2
16.3	17	16.7	16.3	17	16.7
15.7	15.6	15	15.7	15.6	15
44	40	45	44	40	45
600	600	600	670	670	670

•	•	•	•	•	•
—	•	—	•	•	•
—	—	—	•	•	•
•	•	•	•	•	•

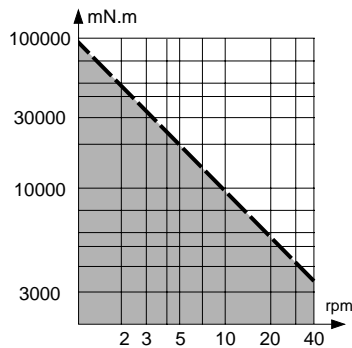
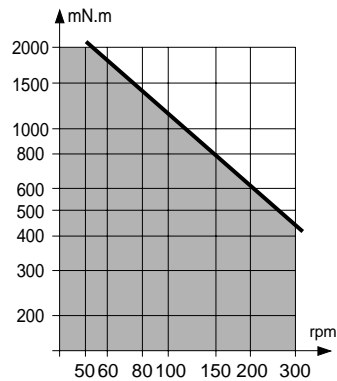

Dimensions 82 802 0

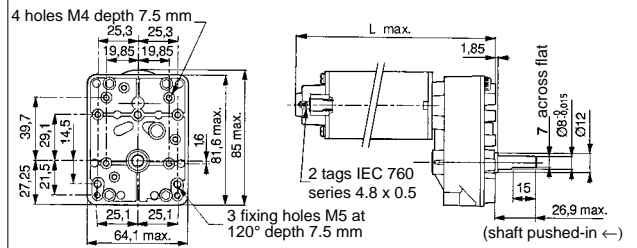

- 1
- 2
- 3

Type	L max. (mm)
82 802 0 standard	126
82 802 0 encoder	140.2

80 803 0

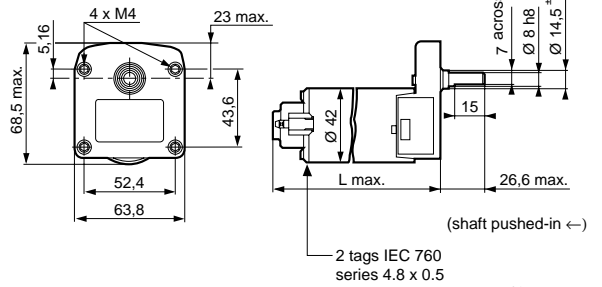

80 804 0

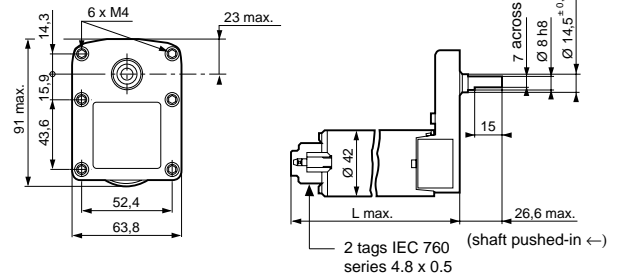

Type	L max. (mm)
80 803 0 / 804 0 standard	98.4
80 803 0 / 804 0 encoder	113

- 4

Non stocked product : gearbox output shaft

Shaft 79 261 300

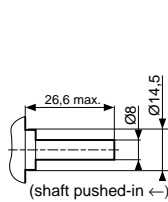

Shaft 79 261 314 only for 80 804 0

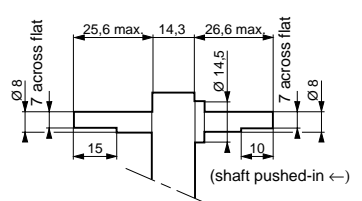

Shaft 79 261 309

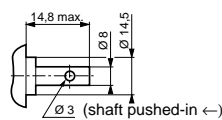

To order, specify :

Standard products

- 3

Part number
Example : D.C. geared motor - 82 800 005

Standard products, non stocked

- 1

Type
Example : D.C. geared motor 82 802 0 - 24 V - 130 rpm - magnetic encoder 1 pulse per revolution (SP 1737.00)

- 2

Nominal voltage

- 3

Output speeds

- 4

Option