

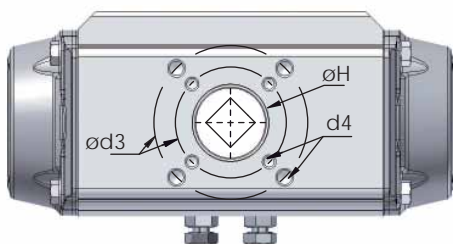

Dimensions in mm

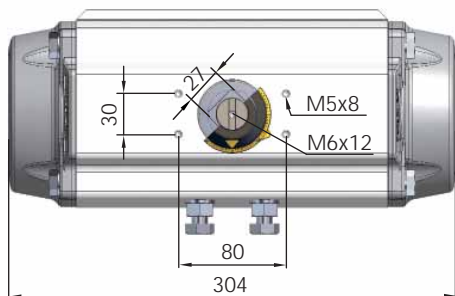

optional squares

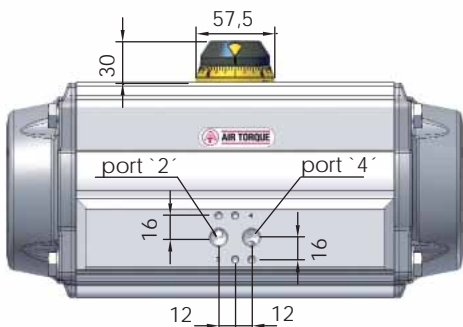
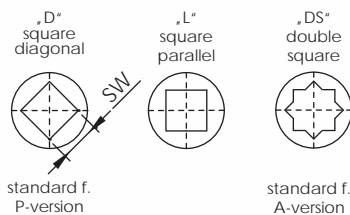

ISO 5211 - available flanges

ISO 5211	Standard		optional
	F07* + F10	F10	F10
Ø d2	55	-	70
Ø d3	70	102	102
d4	M8x12	M10x15	M10 x 15
Ø H	55		70
SW x l min.	D	-	14 x 18 - 22 x 24
	DS	22 x 30	17 x 24 - 22 x 30
h min.	1,5	1,5	1,5
h1	2	-	2

*before selecting the flange connection please consider the indications of standard n° 5211 on page 0911 of our manual for op. and maintenance

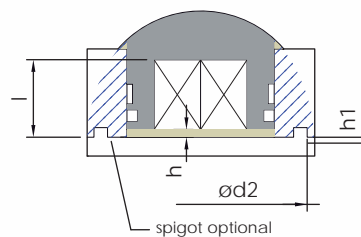

Connection / Attachment

Pressure connection port 2 and 4	G1/4"
Ancillaries attachment	AA 2

Rotation and stroke adjustment

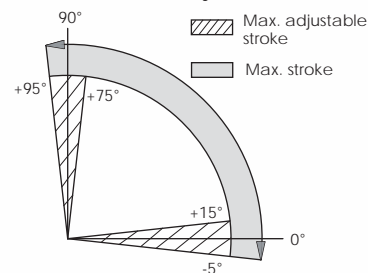

Pressure	Output torque for double acting and spring return in Nm												Spring torque 90°	approx. weight in kg										
	2,5 bar		3 bar		3,5 bar		4 bar		4,2 bar		4,5 bar				5 bar		5,5 bar		6 bar		7 bar		8 bar	
	0°	90°	0°	90°	0°	90°	0°	90°	0°	90°	0°	90°			0°	90°	0°	90°	0°	90°	0°	90°	0°	90°
DR	107	129	150	172	181	193	215	236	258	301	344	-	8,07											

SC 2/3	66,5	41,9	87,9	63,4	109	84,9	131	106	140	115	152	128	174	149									65,5	41	8,62					
SC 3	58,3	28,8	79,7	50,3	101	71,8	123	93,3	131	102	144	115	166	136	187	158										78,6	49,2	8,73		
SC 3/4			71,5	37,2	93	58,7	115	80,2	123	88,8	136	102	158	123	179	145	200	166										91,7	57,4	8,84
SC 4					84,8	45,6	106	67,1	115	75,7	128	88,6	149	110	171	132	192	153	235,3	196								105	65,6	8,95
SC 4/5							98,1	54	107	62,6	120	75,5	141	97	163	118	184	140	227,1	183	270	226						118	73,8	9,06
SC 5											111	62,4	133	83,9	154	105	176	127	218,9	170	262	213						131	82	9,17
SC 5/6													125	70,8	146	92,3	168	114	210,7	157	254	200						144	90,2	9,28
SC 6															138	79,2	159	101	202,5	144	245	187						157	98,4	9,39

Pressure max.	Rotation (STD) (C)	Screw stroke adjustment	Chamber (Ø mm)	Air volume (l)		Moving time (sec.) (A)	
				OPEN	CLOSE	OPEN	CLOSE
8 bar	0° - 90°	for 1° 1/5 rotation	115	1,19	1,8	D 0,70 S 0,90	D 0,80 S 1,10

Operating temperature (°C) (B)		
ST (Standard)	HT (High temperature)	LLT (Extreme low temperature)
- 40 to + 80	- 15 to + 150	- 55 to + 80

(A) The above indicated moving time of the actuator is obtained under the following test conditions: (1) room temperature, (2) actuator stroke 90°, (3) solenoid valve with Ø 4 mm and flow capacity Qn 400 L/min., (4) inside pipe Ø 8 mm, (5) medium clean air, (6) air supply pressure 5,5 bar (79,75 Psi), (7) actuator without external resistance load. **Caution:** It has to be expected, e.g. for field applications, when one or more of the above parameters are different, the moving time will be different.

(B) Every temperature range option requires proper components and lubricant. Please contact Air Torque GmbH.

Operating Medium:

The operating medium must be free of dust and oil. The maximum particle size must not exceed 30µ. (ISO 8573 Part1, Class5). In order to prevent water condensation and/or solidification (ice when actuator works below 0°C), the operating medium must have a dew point equal to -20°C or at least 10°C below the ambient temperature (ISO 8573 Part1, Class3)