

HYDRAULIC MOTORS MLHR

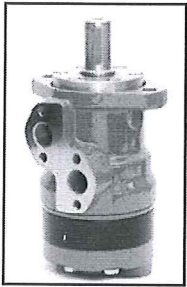

APPLICATION

- » Conveyors
- » Feeding mechanism of robots and manipulators
- » Metal working machines
- » Textile machines
- » Agricultural machines
- » Food industries
- » Grass cutting machinery etc.

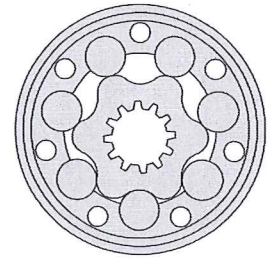

CONTENTS

Specification data34+35
 Function diagrams36+40
 Dimensions and mounting 41+42
 Shaft extensions 28+29
 Permissible shaft loads 30
 Permissible shaft Seal Pressure ... 31
 Order code43

OPTIONS

- » Model - Spool valve, roll-gerotor
- » Flange mount
- » Motor with needle bearing
- » Side and rear ports
- » Shafts - straight, splined and tapered
- » SAE, Metric and BSPP ports
- » Speed sensing
- » Other special features

GENERAL

Max. Displacement, in ³ /rev [cm ³ /rev]	24.4 [397]
Max. Speed, [RPM]	970
Max. Torque, lb-in [daNm]	cont.: 5400 [61] int.: 6100 [69]
Max. Output, HP [kW]	20.1 [15]
Max. Pressure Drop, PSI [bar]	cont.: 2540 [175] int.: 2900 [200]
Max. Oil Flow, GPM [lpm]	19.8 [75]
Min. Speed, [RPM]	10
Pressure fluid	Mineral based- HLP(DIN 51524) or HM(ISO 6743/4)
Temperature range, °F [°C]	-40÷284 [-40÷140]
Optimal Viscosity range, SUS [mm ² /s]	98÷347 [20÷75]
Filtration	ISO code 20/16 (Min. recommended fluid filtration of 25 microns)

Oil flow in drain line

Pressure drop PSI [bar]	Viscosity SUS [mm ² /s]	Oil flow in drain line GPM [lpm]
1450 [100]	98 [20]	.660 [2,5]
	164 [35]	.476 [1,8]
2030 [140]	98 [20]	.925 [3,5]
	164 [35]	.740 [2,8]

Pressure Losses

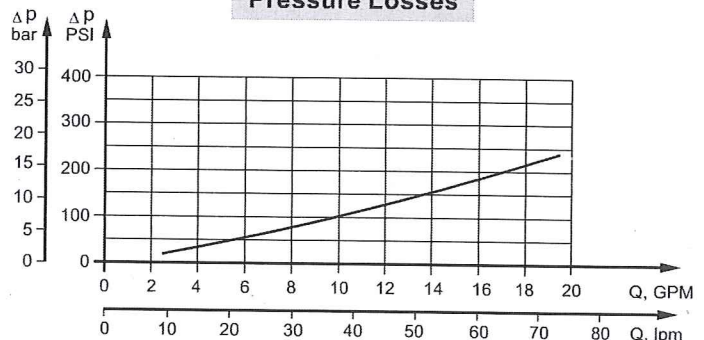

DIMENSIONS AND MOUNTING DATA

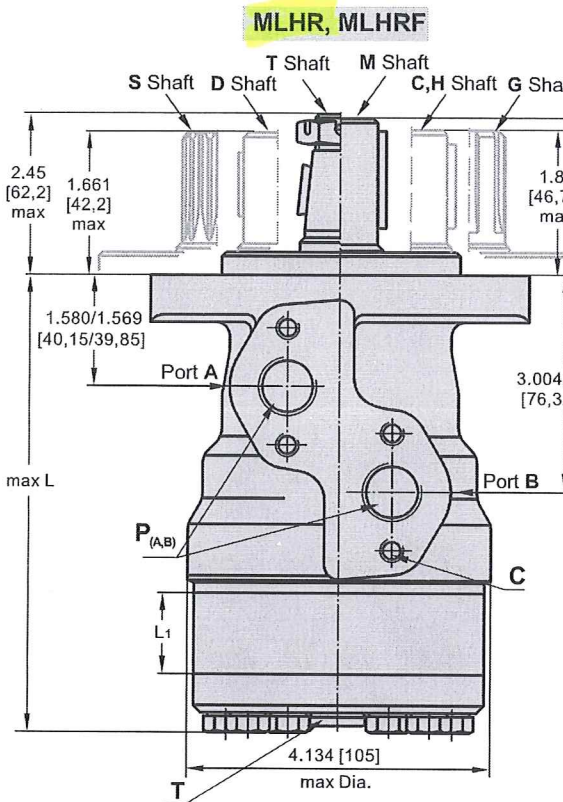

Shaft Dim.
See Page 28

Flange Dim.
See Page 42

Port Dim.
See Page 42

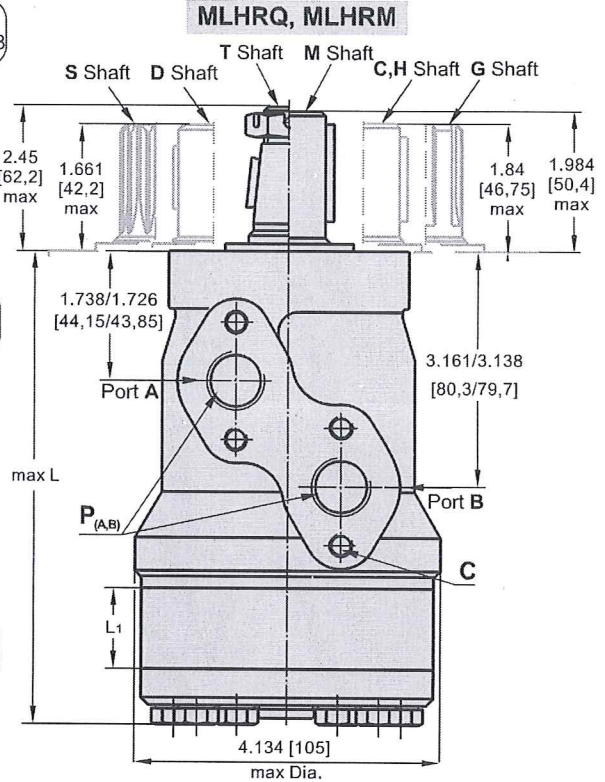

Version **6 7 8 9**
Rear ports

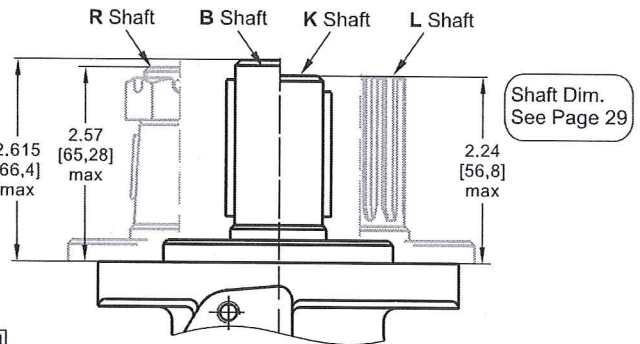
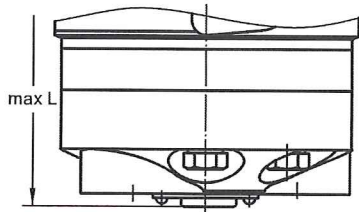

Shaft Dim.
See Page 29

in [mm]

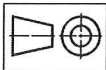

	Versions			
	2, 6	3, 9	4, 7	5, 8
C	4xM8	4xM8	4x $\frac{3}{16}$ -18 UNC	4x $\frac{3}{16}$ -18 UNC
P_(A,B)	2xG $\frac{1}{2}$	2xM22x1,5	2x $\frac{7}{16}$ -14 UNF	2x $\frac{1}{2}$ -14 NPTF
T	G $\frac{1}{4}$	M14x1,5	$\frac{1}{16}$ -20 UNF	$\frac{1}{16}$ -20 UNF

Standard Rotation

Viewed from Shaft End
Port A Pressurized - CW
Port B Pressurized - CCW

Reverse Rotation

Viewed from Shaft End
Port A Pressurized - CCW
Port B Pressurized - CW

Type	L _{max} , in [mm]		Type	L _{max} , in [mm]		L ₁ , in [mm]
	Versions 2,3,4,5	*Versions 6,7,8,9		Versions 2,3,4,5	*Versions 6,7,8,9	
MLHR(F) 50	5.51 [140,0]	6.24 [158,5]	MLHRQ(M) 50	5.69 [144,5]	6.42 [163,0]	.35 [9,0]
MLHR(F) 80	5.71 [145,0]	6.44 [163,5]	MLHRQ(M) 80	5.88 [149,5]	6.61 [168,0]	.55 [14,0]
MLHR(F) 100	5.85 [148,5]	6.58 [167,0]	MLHRQ(M) 100	6.02 [153,0]	6.73 [171,0]	.69 [17,4]
MLHR(F) 125	6.02 [153,0]	6.75 [171,5]	MLHRQ(M) 125	6.18 [157,0]	6.91 [175,5]	.86 [21,8]
MLHR(F) 160	6.26 [159,0]	6.99 [177,5]	MLHRQ(M) 160	6.42 [163,0]	7.14 [181,5]	1.09 [27,8]
MLHR(F) 200	6.54 [166,0]	7.26 [184,5]	MLHRQ(M) 200	6.69 [170,0]	7.42 [188,5]	1.37 [34,8]
MLHR(F) 250	6.87 [174,5]	7.60 [193,0]	MLHRQ(M) 250	7.05 [179,0]	7.78 [187,5]	1.71 [43,5]
MLHR(F) 315	7.32 [186,0]	8.05 [204,5]	MLHRQ(M) 315	7.48 [190,0]	8.21 [208,5]	2.16 [54,8]
MLHR(F) 400	7.89 [200,5]	8.62 [219,0]	MLHRQ(M) 400	8.07 [205,0]	8.78 [223,0]	2.73 [69,4]

* -For Rear Ported Motors.

MOUNTING

SAE A Flange

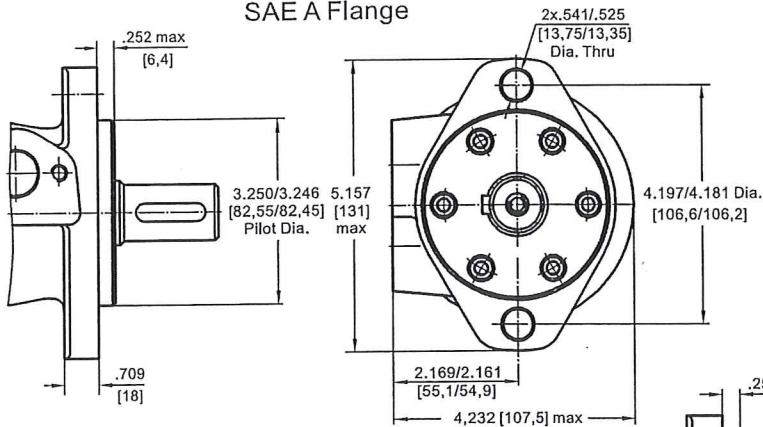

F - Magneto Flange

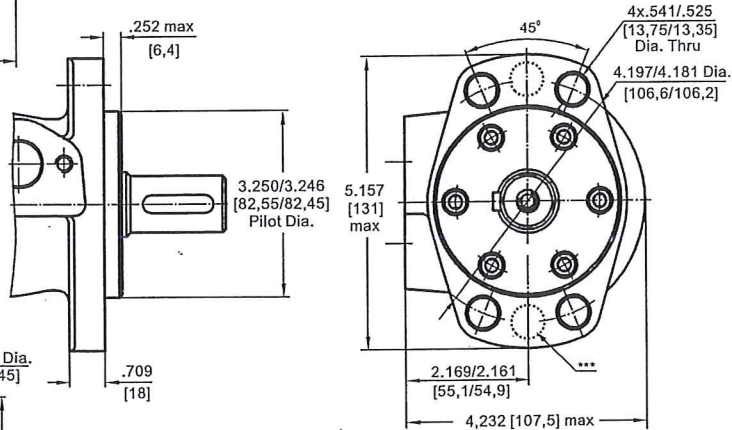

M and **Q** - Square Flange

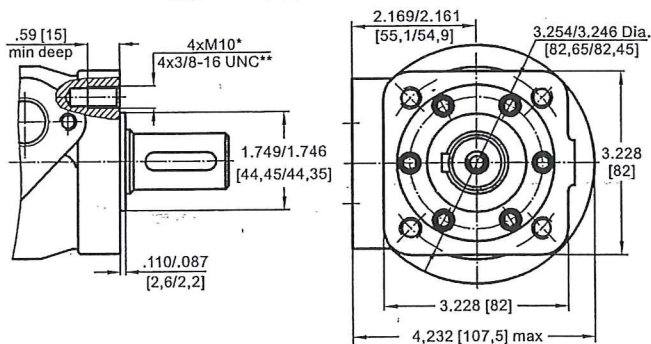

* For M Flange
** For Q Flange
*** Perform at customer's request



PORTS

Side Ports

Version **2** **3** **4** **5**

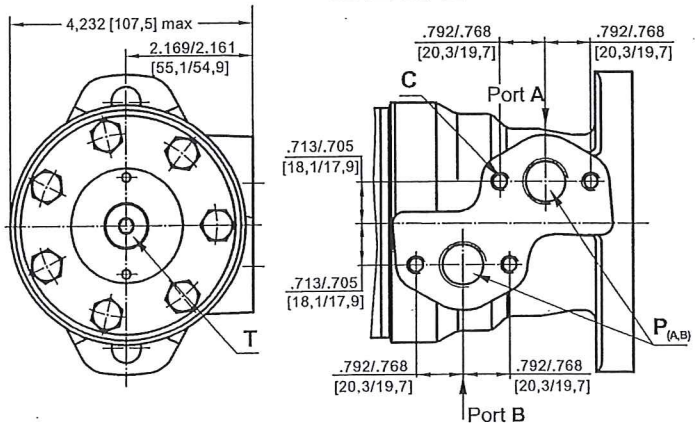

Rear Ports

Version **6** **7** **8** **9**

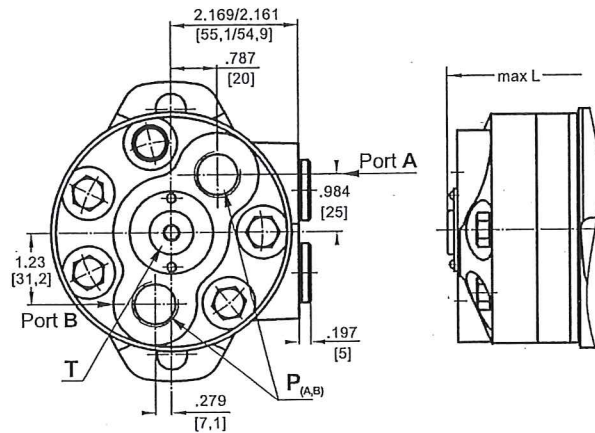

Standard Rotation
Viewed from Shaft End
Port A Pressurized - CW
Port B Pressurized - CCW

Reverse Rotation
Viewed from Shaft End
Port A Pressurized - CCW
Port B Pressurized - CW

	Versions			
	2 , 6	3 , 9	4 , 7	5 , 8
C	4xM8	4xM8	4x $\frac{3}{16}$ -18 UNC	4x $\frac{3}{16}$ -18 UNC
P _(A,B)	2xG $\frac{1}{2}$	2xM22x1,5	2x $\frac{1}{8}$ -14 UNF	2x $\frac{1}{2}$ -14 NPTF
T	G $\frac{1}{4}$	M14x1,5	$\frac{1}{16}$ -20 UNF	$\frac{1}{16}$ -20 UNF



SPECIFICATION DATA

Specification Data for MLHR... motors with **C, D, G, H, M, S** and **T** shafts.
(1.124 [28,56] sealing diameter)



Type		MLHR 50	MLHR 80	MLHR 100	MLHR 125	MLHR 160	MLHR 200	MLHR 250	MLHR 315	MLHR 400
Displacement, in ³ /rev [cm ³ /rev]		3.14	4.90	6.09	7.67	9.74	12.19	15.26	19.26	24.4
		[51,5]	[80,3]	[99,8]	[125,7]	[159,6]	[199,8]	[250,1]	[315,7]	[397]
Max. Speed, [RPM]	Cont.	775	750	600	475	375	300	240	190	150
	Int.*	970	940	750	600	470	375	300	240	190
Max. Torque lb-in [daNm]	Cont.	900 [10,1]	1725 [19,5]	2125 [24]	2655 [30]	3450 [39]	3410 [38,5]	3450 [39]	3450 [39]	3360 [38]
	Int.*	1150 [13]	1947 [22]	2480 [28]	3010 [34]	3805 [43]	4070 [46]	5150 [58]	5045 [57]	5310 [60]
	Peak**	1505 [17]	2390 [27]	2832 [32]	3275 [37]	4070 [46]	4960 [56]	6280 [71]	7400 [83]	7700 [87]
Max. Output HP [kW]	Cont.	9.5 [7]	17 [12,5]	17.4 [13]	16.8 [12,5]	15.4 [11,5]	12 [9]	8.7 [6,5]	8 [6]	6.4 [4,8]
	Int.*	11.9 [8,5]	20.1 [15]	20.1 [15]	19.5 [14,5]	18.8 [14]	15.4 [11,5]	14.1 [10,5]	12.9 [9,6]	11.8 [8,8]
Max. Pressure Drop PSI [bar]	Cont.	2030 [140]	2540 [175]	2540 [175]	2540 [175]	2540 [175]	2030 [140]	1600 [110]	1300 [90]	1020 [70]
	Int.*	2540 [175]	2900 [200]	2900 [200]	2900 [200]	2900 [200]	2540 [175]	2540 [175]	2030 [140]	1670 [115]
	Peak**	3260 [225]	3260 [225]	3260 [225]	3260 [225]	3260 [225]	3260 [225]	3260 [225]	3045 [210]	2540 [175]
Max. Oil Flow GPM [lpm]	Cont.	10.5 [40]	15.8 [60]	15.8 [60]	15.8 [60]	15.8 [60]	15.8 [60]	15.8 [60]	15.8 [60]	15.8 [60]
	Int.*	13.2 [50]	19.8 [75]	19.8 [75]	19.8 [75]	19.8 [75]	19.8 [75]	19.8 [75]	19.8 [75]	19.8 [75]
Max. Inlet Pressure PSI [bar]	Cont.	2540 [175]	2540 [175]	2540 [175]	2540 [175]	2540 [175]	2540 [175]	2540 [175]	2540 [175]	2540 [175]
	Int.*	2900 [200]	2900 [200]	2900 [200]	2900 [200]	2900 [200]	2900 [200]	2900 [200]	2900 [200]	2900 [200]
	Peak**	3260 [225]	3260 [225]	3260 [225]	3260 [225]	3260 [225]	3260 [225]	3260 [225]	3260 [225]	3260 [225]
Max. Return Pres- sure with Drain Line PSI [bar]	Cont.	2540 [175]	2540 [175]	2540 [175]	2540 [175]	2540 [175]	2540 [175]	2540 [175]	2540 [175]	2540 [175]
	Int.*	2900 [200]	2900 [200]	2900 [200]	2900 [200]	2900 [200]	2900 [200]	2900 [200]	2900 [200]	2900 [200]
	Peak**	3260 [225]	3260 [225]	3260 [225]	3260 [225]	3260 [225]	3260 [225]	3260 [225]	3260 [225]	3260 [225]
Max. Starting Pressure with Unloaded Shaft, PSI [bar]		145 [10]	145 [10]	145 [10]	130 [9]	102 [7]	73 [5]	58 [4]	44 [3]	44 [3]
Min. Starting Torque lb-in [daNm]	At max.press.									
	drop Cont.	710 [8]	1330 [15]	1770 [20]	2215 [25]	2832 [32]	2920 [33]	2740 [31]	2920 [33]	2650 [30]
	drop Int.*	85 [10]	1505 [17]	2035 [23]	2480 [28]	3275 [37]	3540 [40]	4250 [48]	5220 [58]	4425 [50]
Min. Speed***, [RPM]		10	10	10	10	10	10	10	10	10
Weight, lb [kg]	MLHR(F)(N)	15 [6,8]	15.2 [6,9]	15.9 [7,2]	16.1 [7,3]	15.2 [7,5]	17.6 [8]	18.5 [8,4]	20 [9,1]	21.6 [9,8]
	For rear ports +1.433 [0,650] MLHRQ(M)(N)	13.7 [6,2]	13.9 [6,3]	14.6 [6,6]	15 [6,8]	15.4 [7,6]	14.7 [7,2]	17.2 [7,8]	19 [8,6]	20.5 [9,3]

* Intermittent operation: the permissible values may occur for max. 10% of every minute.

** Peak load: the permissible values may occur for max. 1% of every minute.

*** For speeds lower than given, consult factory or your regional manager.

- Intermittent speed and intermittent pressure must not occur simultaneously.
- Recommended filtration is per ISO cleanliness code 20/16. A nominal filtration of 25 micron or better.
- Recommend using a premium quality, anti-wear type mineral based hydraulic oil HLP(DIN51524) or HM (ISO 6743/4).
If using synthetic fluids consult the factory for alternative seal materials.
- Recommended minimum oil viscosity 70 SUS [13 mm²/s] at 122°F [50°C].
- Recommended maximum system operating temperature is 180°F [82°C].
- To assure optimum motor life fill with fluid prior to loading and run at moderate load and speed for 10-15 minutes.



SPECIFICATION DATA (continued)

Specification Data for MLHR... motors with **B, K, R** and **L** shafts.
(1.378 [35] sealing diameter)

Type		MLHR 50	MLHR 80	MLHR 100	MLHR 125	MLHR 160	MLHR 200	MLHR 250	MLHR 315	MLHR 400
Displacement, in ³ /rev [cm ³ /rev]		3.14	4.90	6.09	7.67	9.74	12.19	15.26	19.26	24.4
		[51,5]	[80,3]	[99,8]	[125,7]	[159,6]	[199,8]	[250,1]	[315,7]	[397]
Max. Speed, [RPM]	Cont.	775	750	600	475	375	300	240	190	150
	Int.*	970	940	750	600	470	375	300	240	190
Max. Torque lb-in [daNm]	Cont.	900 [10,1]	1725 [19,5]	2125 [24]	2655 [30]	3450 [39]	4000 [45]	4780 [54]	4870 [55]	5400 [61]
	Int.*	1150 [13]	1947 [22]	2480 [28]	3010 [34]	3805 [43]	4425 [50]	5400 [61]	5580 [63]	6100 [69]
	Peak**	1505 [17]	2390 [27]	2832 [32]	3275 [37]	4070 [46]	4960 [56]	6280 [71]	7350 [83]	7700 [87]
Max. Output HP [kW]	Cont.	9.5 [7]	17 [12,5]	17.4 [13]	16.8 [12,5]	15.4 [11,5]	14.8 [11]	13.4 [10]	12 [9]	10.5 [7,8]
	Int.*	11.9 [8,5]	20.1 [15]	20.1 [15]	19.5 [14,5]	18.8 [14]	17.4 [13]	16.1 [12]	14.8 [11]	14.2 [10,6]
Max. Pressure Drop PSI [bar]	Cont.	2030 [140]	2540 [175]	2540 [175]	2540 [175]	2540 [175]	2540 [175]	2540 [175]	1960 [135]	1670 [115]
	Int.*	2540 [175]	2900 [200]	2900 [200]	2900 [200]	2900 [200]	2900 [200]	2900 [200]	2320 [160]	2030 [140]
	Peak**	3260 [225]	3260 [225]	3260 [225]	3260 [225]	3260 [225]	3260 [225]	3260 [225]	3045 [210]	2540 [175]
Max. Oil Flow GPM [lpm]	Cont.	10.5 [40]	15.8 [60]	15.8 [60]	15.8 [60]	15.8 [60]	15.8 [60]	15.8 [60]	15.8 [60]	15.8 [60]
	Int.*	13.2 [50]	19.8 [75]	19.8 [75]	19.8 [75]	19.8 [75]	19.8 [75]	19.8 [75]	19.8 [75]	19.8 [75]
Max. Inlet Pressure PSI [bar]	Cont.	2540 [175]	2540 [175]	2540 [175]	2540 [175]	2540 [175]	2540 [175]	2540 [175]	2540 [175]	2540 [175]
	Int.*	2900 [200]	2900 [200]	2900 [200]	2900 [200]	2900 [200]	2900 [200]	2900 [200]	2900 [200]	2900 [200]
	Peak**	3260 [225]	3260 [225]	3260 [225]	3260 [225]	3260 [225]	3260 [225]	3260 [225]	3260 [225]	3260 [225]
Max. Return Pres- sure with Drain Line PSI [bar]	Cont.	2540 [175]	2540 [175]	2540 [175]	2540 [175]	2540 [175]	2540 [175]	2540 [175]	2540 [175]	2540 [175]
	Int.*	2900 [200]	2900 [200]	2900 [200]	2900 [200]	2900 [200]	2900 [200]	2900 [200]	2900 [200]	2900 [200]
	Peak**	3260 [225]	3260 [225]	3260 [225]	3260 [225]	3260 [225]	3260 [225]	3260 [225]	3260 [225]	3260 [225]
Max. Starting Pressure with Unloaded Shaft, PSI [bar]		145 [10]	145 [10]	145 [10]	130 [9]	102 [7]	73 [5]	58 [4]	44 [3]	44 [3]
Min. Starting Torque lb-in [daNm]	At max.press. drop Cont.	710 [8]	1330 [15]	1770 [20]	2215 [25]	2832 [32]	3630 [41]	4000 [45]	4000 [45]	4340 [49]
	At max.press. drop Int.*	885 [10]	1505 [17]	2035 [23]	2480 [28]	3275 [37]	4070 [46]	4870 [55]	5840 [66]	5400 [61]
Min. Speed***, [RPM]		10	10	10	10	10	10	10	10	10
Weight, lb [kg] For rear ports +1.433 [0,650]		15,2 [6,9]	15,4 [7]	16,1 [7,3]	16,3 [7,4]	15,4 [7,6]	18,9 [8,1]	18,7 [8,5]	20,3 [9,2]	21,8 [9,9]

* Intermittent operation: the permissible values may occur for max. 10% of every minute.

** Peak load: the permissible values may occur for max. 1% of every minute.

*** For speeds lower than given, consult factory or your regional manager.

- Intermittent speed and intermittent pressure must not occur simultaneously.
- Recommended filtration is per ISO cleanliness code 20/16. A nominal filtration of 25 micron or better.
- Recommend using a premium quality, anti-wear type mineral based hydraulic oil HLP(DIN51524) or HM (ISO 6743/4).
If using synthetic fluids consult the factory for alternative seal materials.
- Recommended minimum oil viscosity 70 SUS [13 mm²/s] at 122°F [50°C].
- Recommended maximum system operating temperature is 180°F [82°C].
- To assure optimum motor life fill with fluid prior to loading and run at moderate load and speed for 10-15 minutes.

ORDER CODE

	1	2	3	4	5	6	7	8	9
M L H R									

Pos.1 - Mounting Flange

omit - SAE A, two holes

F - Magneto, four holes (six holes at customer's request)

M - Square metric, four bolts M10

Q - Square, four bolts

Pos.2 - Displacement code

50 - 3.14 in³/rev [51,5 cm³/rev]

80 - 4.90 in³/rev [80,3 cm³/rev]

100 - 6.09 in³/rev [99,8 cm³/rev]

125 - 7.67 in³/rev [125,7 cm³/rev]

160 - 9.74 in³/rev [159,6 cm³/rev]

200 - 12.19 in³/rev [199,8 cm³/rev]

250 - 15.26 in³/rev [250,1 cm³/rev]

315 - 19.26 in³/rev [315,7 cm³/rev]

400 - 24.40 in³/rev [397,0 cm³/rev]

Pos.3 - Shaft Extensions* [see pages 28 and 29]

C - 1" [25,4] straight, Parallel key

VC - 1" [25,4] straight, Parallel key w/ corrosion resistant bushing

D - 7/8" [22,2] straight, Parallel key

G - 1" [25,4] SAE 6B Splined

H - 1" [25,4] straight w/ .406 [10,3] Crosshole

M - 25 mm straight, Parallel key

VM - 25 mm straight, Parallel key w/ corrosion resistant bushing

S - 7/8" [22,2] 13T Splined

T - 1" [25,4] SAE J501 Tapered

B - 32 mm straight, Parallel key

K - 1 1/4" [31,75] straight, Parallel key

L - 1 1/4" [31,75] 14T Splined

R - 1 1/4" [31,75] SAE J501 Tapered

Pos.4 - Option [needle bearings]

omit - none

N - with needle bearings

Pos.5 - Port Size/Type [standard manifold to each]

2 - side ports, 2xG1/2, G1/4, BSP thread, ISO 228

3 - side ports, 2xM22x1,5, M14x1,5, metric thread, ISO 262

4 - side ports, 2x7/8-14 UNF, O-ring, 7/16-20 UNF

5 - side ports, 2x1/2-14 NPTF, 7/16-20 UNF

6 - rear ports, 2xG1/2, G1/4, BSP thread, ISO 228

7 - rear ports, 2x7/8-14 UNF, O-ring, 7/16-20 UNF

8 - rear ports, 2x1/2-14 NPTF, 7/16-20 UNF

9 - rear ports, 2xM22x1,5, M14x1,5, metric thread, ISO 262

Pos.6 - Shaft Seal Version [see page 31]

omit - Standard shaft seal

U - High pressure shaft seal (without check valves)

Pos.7 - Drain Port

omit - with drain port

1 - without drain port

Pos.8 - Special Features [see page 102]

Pos.9 - Design Series

omit - Factory specified

Notes:

The following combinations are not allowed: - **Q** and **M** flange with **B, K, L, R** shafts;
 - **N** option with **B, K, L, R** shafts, **U** option or **RS** option;
 - **B, K, L, R** shafts with **U** option.

* The permissible output torque for shafts must not be exceeded!

The hydraulic motors are manganese-phosphatized as standard.