

# Flange ball valve with CETOP connection Steel

KH-CET

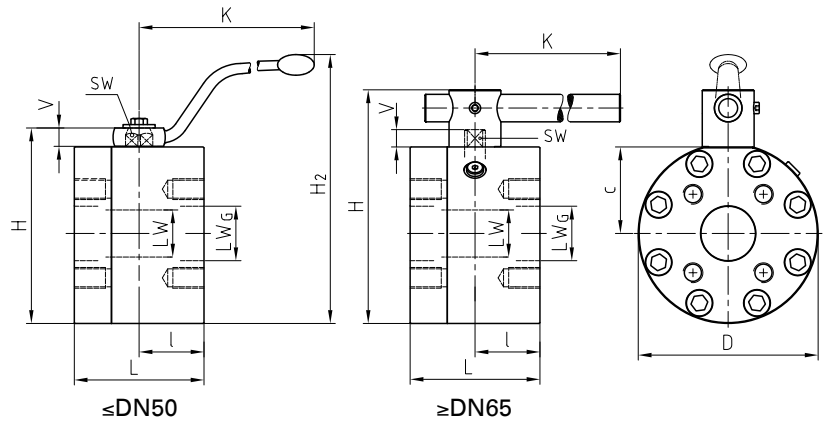
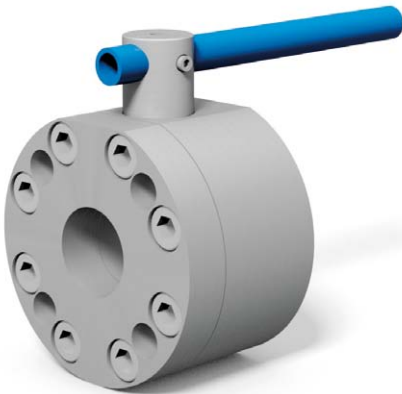

## AVAILABLE SIZES

DN40 - DN100 (1 1/2" to 4")

## CONNECTIONS

CETOP 250 bar, CETOP 400 bar

## ACCESSORIES ON REQUEST

- Locking devices page 222 - 226
- Actuators 220 - 221
- Mounting holes on request
- Position switches on request
- Combinations on request
- Detent on request

## MATERIAL CODE DESCRIPTION

Materials	DN15-50 212A	DN15-50 2128	DN65-100 282A	DN65-100 2828
Body	Steel	Steel	Steel	Steel
Ball	Steel	Steel	Steel	Steel
Stem	Steel	Steel	Duplex	Duplex
Ball seats	POM	POM	POM	POM
O-rings	NBR	FPM	NBR	FPM
Tmin /Tmax	-10°C / 100°C	-10°C / 100°C	-10°C / 100°C	-10°C / 100°C

## GENERAL DIMENSIONS CETOP 250 BAR

Type	Flange size	LW	LW <sub>G</sub>	L	I	D	H	c	V	K	SW	H <sub>2</sub>	Lever
KH-DN40	1 1/2"	38	38	110	55	165	178	78	17	306	17	250	St
KH-DN50	2"	48	47	123	58	198	210	94	17	306	17	283	St
KH-DN50	2 1/2"	48	58	123	58	198	210	94	17	306	17	283	St
KH-DN65	3"	63	70	150	75	208	270	100	20	600	19	-	St <sup>(1)</sup>
KH-DN80 (PN100)	3"	76	70	150	75	215	279	100	26	600	19	-	St <sup>(1)</sup>
KH-DN80 (PN250)	3"	76	70	170	78	258	315	114,5	26	600	19	-	St <sup>(1)</sup>
KH-DN100	4"	100	90	200	100	258	326	122	26	900	24	-	St <sup>(1)</sup>

## GENERAL DIMENSIONS CETOP 400 BAR

Type	Flange size	LW	LW <sub>G</sub>	L	I	D	H	c	V	K	SW	H <sub>2</sub>	Lever
KH-DN40	1 1/2"	38	35	110	55	165	178	78	17	306	17	250	St
KH-DN50	2"	48	43	123	58	198	210	94	17	306	17	283	St
KH-DN50	2 1/2"	48	53	123	58	198	210	94	17	306	17	283	St
KH-DN65	3"	63	58	150	75	224	286	108	20	600	19	-	St <sup>(1)</sup>
KH-DN80 (PN100)	4"	76	74	150	70	228	293	107	26	600	19	-	St <sup>(1)</sup>
KH-DN80 (PN400)	4"	76	74	170	78	258	315	114,5	26	600	19	-	St <sup>(1)</sup>

Please note the pressure ratings of the connection flanges!

<sup>(1)</sup> Lever must be fixed centrally during operation. In case of vibration the handle may otherwise operate the valve by itself.

# Flange ball valve with CETOP connection Steel

## KH-CET

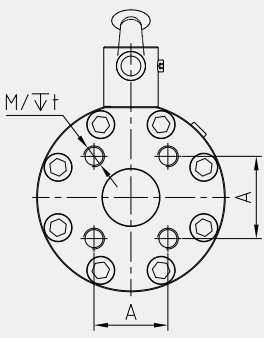
CONNECTION TYPE	DIMENSIONS						ORDER CODE PER MATERIAL COMBINATION		
CETOP 250 bar	Type	Flange size	A	M	t	Weight [Kg]	PN [bar]	212A (282A)	2128 (2828)
	KH-DN40-CET250	1 1/2"	60	M14	24	16,60	250	41915	41918
	KH-DN50-CET250	2"	69,4	M16	24,5	27,00	250	41916	41919
	KH-DN50-CET250	2 1/2"	83,4	M20	33	26,70	250	41798	41920
	KH-DN65-CET250	3"	102,5	M20	33	36,80	250	41799	40774
	KH-DN80-CET250 (PN100)	3"	102,5	M20	37	37,80	100	26710	55486
	<b>KH-DN80-CET250 (PN250)</b>	<b>3"</b>	<b>102,5</b>	<b>M20</b>	<b>37</b>	<b>62,50</b>	<b>250</b>	<b>59301</b>	<b>59646</b>
	KH-DN100-CET250	4"	113,2	M24	40	70,40	250	41917	35922

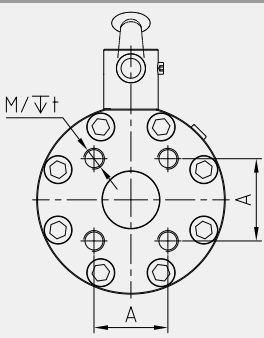
CONNECTION TYPE	DIMENSIONS						ORDER CODE PER MATERIAL COMBINATION		
CETOP 400 bar	Type	Flange size	A	M	t	Weight [Kg]	PN [bar]	212A (282A)	2128 (2828)
	KH-DN40-CET400	1 1/2"	60	M14	24	16,60	400	41921	41922
	KH-DN50-CET400	2"	69,4	M16	24,5	27,10	400	41923	41924
	KH-DN50-CET400	2 1/2"	83,4	M20	31	26,90	400	41925	41926
	KH-DN65-CET400	3"	102,5	M20	37,5	42,70	400	41927	41928
	KH-DN80-CET400 (PN100)	4"	113,2	M24	40	43,00	100	41929	41930
	KH-DN80-CET400 (PN400)	4"	113,2	M24	35	63,00	400	59307	59648

## BYPASS OPTION



When larger ball valves have to be activated at full differential pressure, a smaller ball valve can be used before activation in order to equalize the pressure.

We combine the bypass within the flange valve body to provide less leakage points compared to a piped solution.

- Both main and bypass valve can be offered with locking device or any other accessory like limit switches or actuators.
- Bypass is a standard manifold mounting PKH valve which can be easily maintained or replaced
- Bypass manifold mounting valve provides bubble tight shut off.