



1000-31B LUBRICATION GUN OPERATING INSTRUCTIONS

Contents:

- **1000-31B Parts List**
- **Assembling the 1000-31B Lubrication Gun**
- **Loading the 1000-31B Lubrication Gun**
- **Injecting Material Into Your Valve**

10,000 P.S.I. High Pressure Valve Lubrication Gun

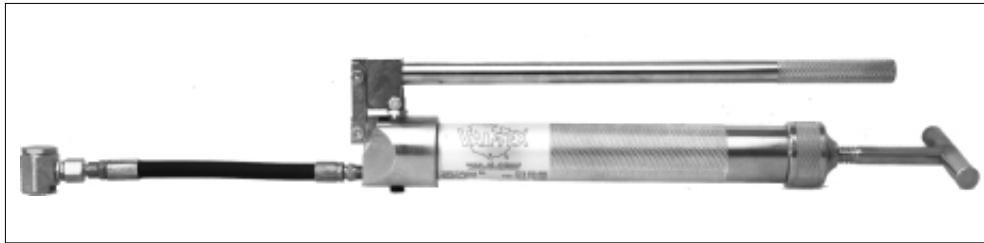

Stick Size: K
PSI Rating: 10,000
Priming: Screw Type
Delivery: 1 oz. / 15 strokes

Weight: 13 Lbs.
Gauge: Optional
Lube Pack Compatible: No
Internal Relief Valve: No

The Val-Tex 1000-31 lever gun accepts standard lube sealant sticks and Valve Flush . The 1000-31 is durable and easily repairable because it has few moving parts.

The standard 1000-31 is shipped as shown above, with hose center, ball bearing swivel, and giant buttonhead coupler with nylon coupler washer. Options such as high pressure hose tee, gauge, gauge guard, carrying strap, Z-swivel, various hose lengths and repair parts are available upon request.

CAUTION: This gun is not equipped with an internal ball check in the head assembly and line pressure may bleed back into the barrel. Before removing the giant buttonhead coupler, turn the screw handle counterclockwise and raise the plunger handle to relieve pressure.

1000-21-31: Hose assembly complete (no gauge)
1000A-31G: Gun complete with gauge assembly

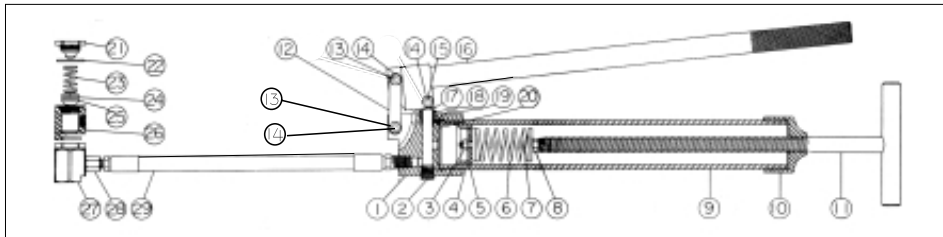

Item	Part No.	Description
1	1000-1	Head
2	1000-2	Pipe Plug
3	1000-3	Nut
4	1000-4	Primer Cup
5	1000-5	Washer
6	1000-6	Primer Spring
7	1000-7	Screw
8	1000-8	Nut
9	1000-9	Barrel
10	1000-10	Collar
11	1000-11	Screw Handle
12	1000-12	Link (2 required)
13	1000-13	Link Stud (2 required)
14	1000-14	Lock Nut (3 required)
15	1000-15	Stripper Bolt
16	1000-16	Plunger Handle
17	1000-17	Plunger
18	1000-18	Packing Nut
19	1000-19	Packing

Item	Part No.	Description
20	1000-20	Head Gasket (optional)
21	1000-21	Coupler Cap
22	1000-22	Coupler Seal
23	1000-23	Coupler Spring
24	1000-24	"O" Ring
25	1000-25	Coupler Piston
26	1000-26	Coupler Body
27	1000-27	Coupler Assy
28	1000-30	Swivel 1/8"x1/8" NPTF
29	1000-29	Hose - 10"
	OPTIONS	
	.25 TEE	High Pressure Hose Tee
	1422	Carrying Strap
	15MGF	High Pressure Gauge
	52752	Z-Swivel
	301296	High Pressure Tee Adapter
	319700	Shut-off / Bleeder Valve
	GC-250	Gauge Guard
		Various Hose Lengths

1000-31B Lubrication Gun

Upon receipt thoroughly inspect your 1000-31B lubrication gun for any damage that may have occurred during shipping. If any damage has occurred, immediately contact the carrier in order to initiate a claim.

The 1000-31B comes in 2 types of assemblies. The 1000-31B has a complete hose assembly. The 1000A-31GB is complete with hose assembly and gauge.

Assembling the 1000-31B Lubrication Gun

1. If you have the 1000A-31GB you will need to tighten the gauge (15MGF) in the 1/4" tee (.25 Tee) on the hose assembly.
2. Attach and tighten the hose assembly to the head (1000-1).
3. Your 1000A-31GB Lubrication Gun is now ready to load.

Loading the 1000-3B1 Lubrication Gun

1. Turn the handle (1000-11) counter clockwise to release pressure in the gun. Unscrew the head assembly (1000-1) from the cylinder (1000-9).
2. Continue to unscrew the handle (1000-11) until there is sufficient room to load the required amount of material.
3. Load material.
 - A. Valve Flush: Pour in the required amount.
 - or-**
 - B. "K" size stick: Unwrap the stick and insert it. Rewrap any unused portion.
4. Replace the head assembly (1000-1) onto the cylinder (1000-9) and tighten.
5. Turn the handle (1000-11) clockwise as tight as you can to prime the gun.
6. Your 1000-31B is now ready to inject material into the valve.

Injecting Material Into the Valve

1. The 1000-31B is equipped with a giant buttonhead coupler to inject into a giant buttonhead fitting.
2. It takes approximately 10-20 strokes to prime the gun.
3. After 10-15 strokes retighten the handle (1000-11) to keep material forced to the piston. Repeat as necessary.
4. If your gun is so equipped, monitor the gauge (15MGF) during pumping to avoid excessive pressure.
5. It takes approximately 15 strokes to inject 1 ounce of product.