

Parts

Air Motor Parts List

Ref. No.	Part No.	Description	Qty
1	819.4275	HOUSING, center; alum.	1
	819.0247	HOUSING, center; stainless steel	1
2	819.4276	COVER, air valve; alum.	1
	819.0259	COVER, air valve; stainless steel	1
3	819.0221	SCREW, mach, hex flange hd; M5 x 0.8; 12 mm	9
4†■	819.4278	GASKET, cover; Santoprene®	1
5	819.4279	CARRIAGE; aluminum	1
6†■	819.4280	O-RING; nitrile	1
7†■	819.4281	BLOCK, air valve; acetal	1
8■	Alum. 819.4282	PLATE, air valve; sst	1
	SST 819.0248	PLATE, air valve, sst	1
9†	Alum. 819.4283	SEAL, valve plate; buna-N	1
	SST -	-	-
10†■	819.4284	PACKING, u-cup; nitrile	2
11	819.4285	PISTON, actuator; acetal	2
12	819.4286	BEARING, piston; acetal	2
15	819.4287	BEARING, pin; acetal	2
16	819.4288	PIN, pilot; stainless steel	2
17†■	819.4289	O-RING; buna-N	2
18†■	819.4290	BLOCK, pilot; acetal	1
19	819.4291	BEARING, shaft; acetal	2
20	819.0220	SCREW, grounding	1
22	819.4294	GASKET, air cover; foam	2
23	819.4336	COVER, air; aluminum	2
	819.7107	COVER, air; stainless steel	2
24	819.4337	SHAFT, diaphragm; sst	1
25	819.7051	SCREW; M8 x 1.25; 25 mm, aluminum	12
	819.4297	SCREW; M8 x 1.25; 25 mm, stainless steel	12

Fluid Section Parts List

Fluid section material	Ref. No.	Part No.	Description	Qty
P O L Y P R O P Y L E N E	101	819.4487	COVER, fluid; polypropylene	2
		819.0276	COVER, fluid; conductive polypropylene	2
	102	819.6981	MANIFOLD, inlet; polypropylene	1
		819.0275	MANIFOLD, inlet; conductive polypropylene	1
	103	819.6986	MANIFOLD, outlet; polypropylene	1
		819.0277	MANIFOLD; outlet; conductive polypropylene	1
	104	819.0258	PLATE, air side; aluminum	2
	105	819.4490	PLATE, fluid side; polypropylene	2
	106	819.4375	SCREW; M8 x 1.25; 70 mm; sst	8
	107	819.4491	SCREW; M10 x 1.50; 60 mm; sst	12
	108	819.9752	SCREW; M10 x 1.50; 90 mm; sst	8
	110▲	819.6314	LABEL, warning	1
111	819.7000	MUFFLER	1	
P V D F	101	819.4492	COVER, fluid; PVDF	2
		819.0072	MANIFOLD, inlet; PVDF	1
	103	819.0073	MANIFOLD, outlet; PVDF	1
	104	819.0258	PLATE, air side; aluminum	2
	105	819.4495	PLATE, fluid side; PVDF	2
	106	819.4375	SCREW; M8 x 1.25; 70 mm; sst	8
	107	819.4491	SCREW; M10 x 1.50; 60 mm; sst	12
	108	819.9752	SCREW; M10 x 1.50; 90 mm; sst	8
	110▲	819.6314	LABEL, warning	1
	111	819.7000	MUFFLER	1
	112	819.4377	SCREW; M8 x 1.25; 40 mm; sst	8

Parts

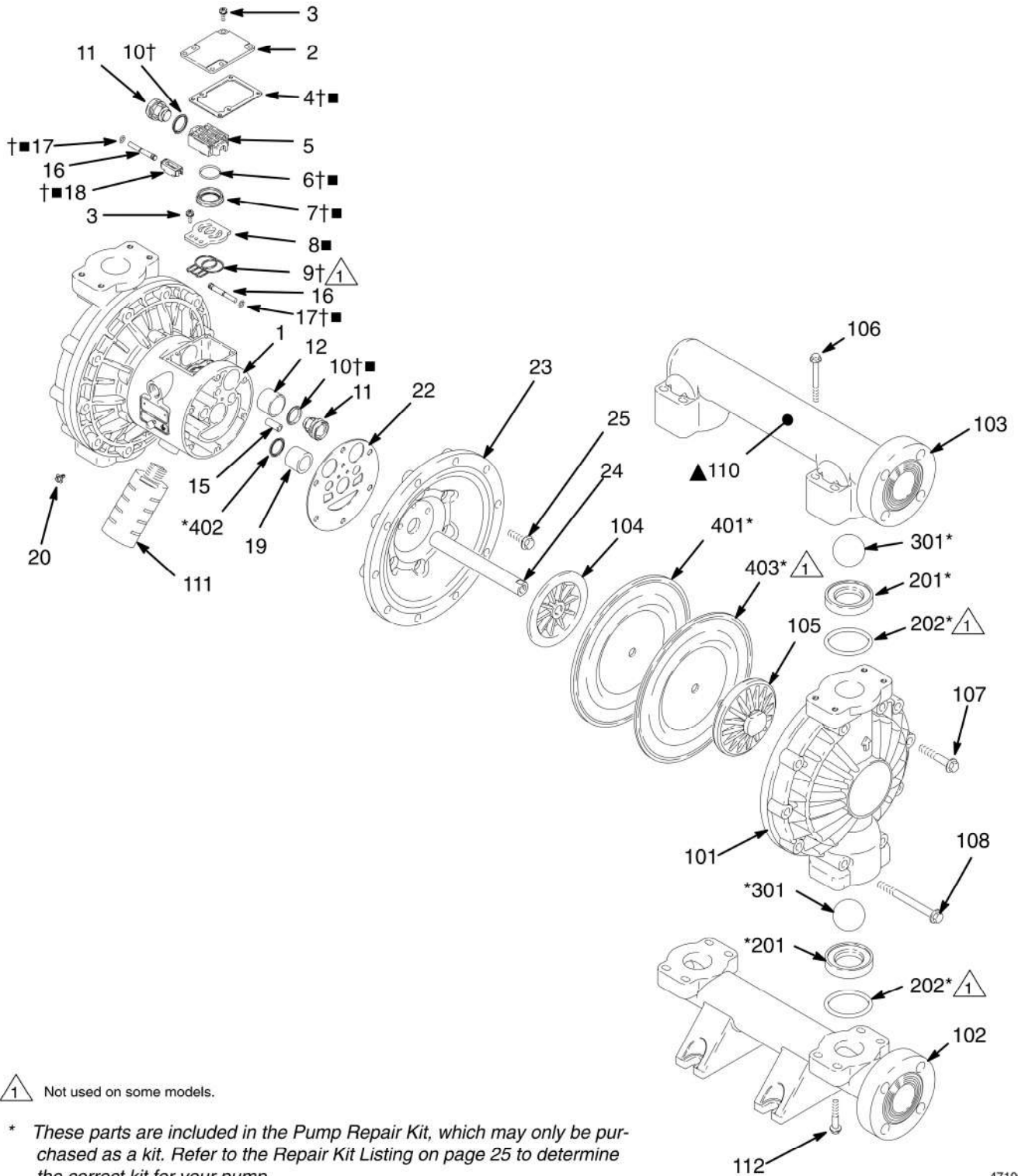

△ Not used on some models.

* These parts are included in the Pump Repair Kit, which may only be purchased as a kit. Refer to the Repair Kit Listing on page 25 to determine the correct kit for your pump.

† These parts are included in Air Valve Repair Kit 819.4274 (aluminum center housing models only), which may only be purchased as a kit.

■ These parts are included in Air Valve Repair Kit 819.0247 (stainless steel center housing models) which may be only be purchased as a kit.

▲ Replacement Danger and Warning labels, tags and cards are available at no cost.

4710C

Parts

Seat Parts List

Seat Material	Ref. No.	Part No.	Description	Qty
3 1 6 S S T	201*	819.4349	SEAT; 316 stainless steel	4
	202*	819.4350	O-RING; PTFE	4
1 7 - 4 P H S S T	201*	819.4351	SEAT; 17-4 stainless steel	4
	202*	819.4350	O-RING; PTFE	4
T P E	201*	819.4352	SEAT; TPE	4
	202	None	Not Used	0
S A N T O P R E N E	201*	819.4353	SEAT; Santoprene	4
	202*	819.4350	O-RING; PTFE	4

B U N A - N	201*	819.7116	SEAT; Buna-N	4
	202*	NONE	NOT USED	0
F L U O R O E L A S T O M E R	201*	819.7114	SEAT; fluoroelastomer	4
	202*	None	Not Used	0
P O L Y P R O P Y L E N E	201*	819.4355	SEAT; polypropylene	4
	202*	819.4350	O-RING; PTFE	4
P V D F	201*	819.4356	SEAT; PVDF	4
	202*	819.4350	O-RING; PTFE	4