

General purpose, top-entry velocity transducer with DC output. Made from robust stainless steel throughout for continuous vibration monitoring in harsh environments. Sealed to IP67 with industry standard two-wire 4-20mA output proportional to sensor range that can connect directly to PLC, DCS and other industrial controllers. Includes integral stainless overbraided ETFE cable and PG7 male thread at cable exit on cap.

## MTN/1185CMPG7-25

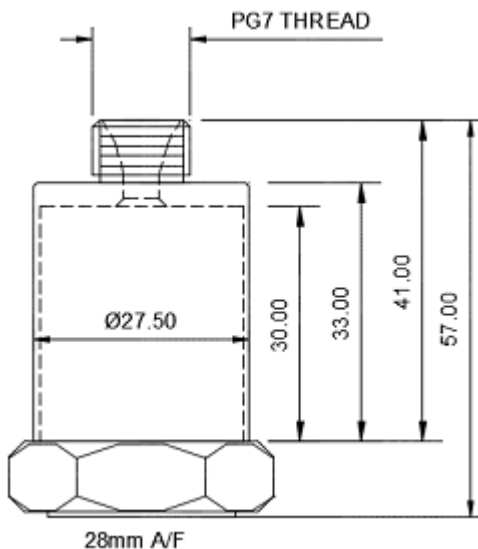

## Dimensions



## Applications

- Air handling units
- Building services
- Fans

## Technical

Output current	4-20mA DC proportional to rms velocity (mm/s)
Supply voltage	12-32V DC (4-20mA)
Frequency response	2Hz to 1kHz $\pm 10\%$
Mounted base resonance	5kHz (nominal)
Isolation	Base isolated
Dynamic range	50g peak
Transverse sensitivity	Less than 5%
Sensitivity	25mm/sec
Operating temperature	-25 to 90°C
Temperature sensitivity	0.08%/°C
Sensitivity	25mm/sec
Cable	Integral stainless steel overbraided ETFE
Standard cable length	5m
Maximum cable length	100m
Mounting torque	8Nm
Weight	150g (nominal)
Sealing	IP67

Order Code Part No	Mounting	Optional Velocity (mm/s rms)
1185CMPG7-25	M10 Male	0-10 0-20
1185CM8PG7-25	M8 Male	0-25 0-50

## System connection

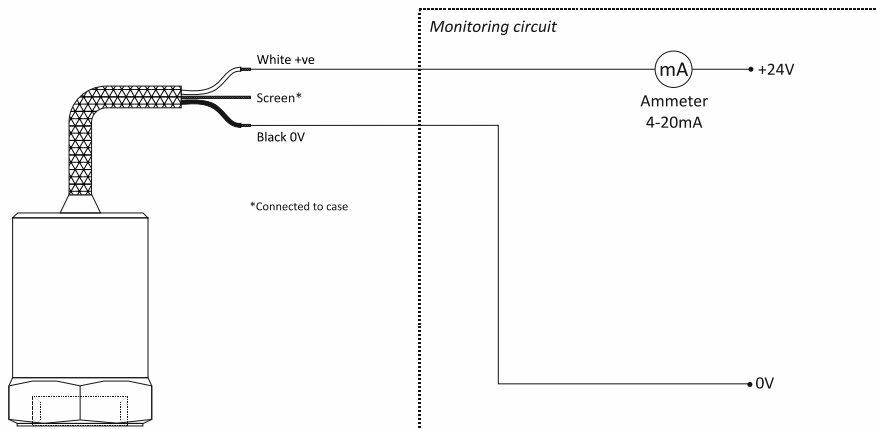

## Monitoring Circuit